



Grams : "KIDU FARM", NETTANA  
E-mai: cpcrirckidu@gmail.com

Phone: (08251) 262221, 262355  
Fax : (08251) 262221

**ICAR - CENTRAL PLANTATION CROPS RESEARCH INSTITUTE**  
(Indian Council of Agricultural Research)  
RESEARCH CENTRE, KIDU, NETTANA – 574 230, D.K., KARNATAKA.



F. No.400-26/2008-IS

Date: 26-11-2015

To

Sub: Quotation for supply & installation of intercom facility – reg.

Sirs,

Sealed quotations are invited for supply & installation of following items at this Station.

Sl. No.	Description of items	Quantity required
01	Supply & installation of intercom facility – Specifications/details attached	As mentioned in enclosure

The quotation should confirm to the following conditions:

01. The rates quoted should be valid for a minimum period of 90 days from the due date of receipt quotation.
02. Complete description, specification of the item(s) quoted with a sample piece should be given for verification.
03. Should indicate time required for effecting the supply upon receipt of supply order.
04. Should indicate the rate of ST/CST/ED/VAT/Entry Tax etc. if charged extra.
05. **Should specify whether the item(s) quoted are under DGS&D rate contract.** If so details of the rate contract should be furnished with the quotation.
06. Supply and Installation: Onsite at CPCRI Research Centre, Kidu, DK, Karnataka.
07. \*Standard Earthing and strong input line protection should be done as part of installation.
08. All the above four items A1, A2 and labour work B1, B2 should be quoted/undertaken by a single firm. No piecemeal / subletting quote is acceptable.
09. All the measurements given in the attached sketch are for information purpose only and may not necessarily match the actual measurements.
10. Tenderers are advised to visit the site and take actual measurements before quoting after taking necessary permission from the SIC.
11. Tenderers should be specialized agencies / contractors having exposure in similar kind of (EPABX cabling and installation) works.
12. A copy of works executed by the tenderer, preferably in Govt. Institutions has to be enclosed along with the quotation.
13. The firm should attend the complaints within 24 hours and rectify the fault as per the satisfaction of the SIC.
14. Detailed, complete and printed technical specification of the unit /components offered by the tenderer SHOULD BE ENCLOSED with the quote.
15. The buyer shall have the right to levy liquidated damages at a percentage not exceeding 10% per each month or part thereof in respect of supplies so delayed and delivered.
16. Guarantee offered for the item(s) should be indicated from the date of receipt of items. Warranty should be minimum for one year for

17. Payment will be made only after satisfactory receipt/installation/demonstration of the item(s)/ by this office. No Advance payment/part payment is admissible as per rules.
18. Quotation received after the due date will not be entertained
19. The items(s) ordered should be supplied in lot. Part supply will not be accepted. The right to accept or reject the quotation rests with the SIC, CPCRI, RC, Kidu.
20. TRANSIT INSURANCE: The purchaser will not pay separately for transit insurance and the supplier will be responsible until the entire stores contracted delivered in good condition at destination.
21. **EARNEST MONEY DEPOSIT @2%** of the quoted amount, if the quote exceeds Rs. 1,00,000/-, must be Deposited in cash or by demand draft drawn In favour of "ICAR, Unit CPCRI, Kasaragod" payable at SBI, CPCRI Branch, Kasaragod along with the quotation.
22. TIN/VAT/ST Reg. no. Should be indicated in the Quotation.
23. If the order value exceeds Rs. 1,00,000/- the successful tenderers shall have to furnish unconditional Performance Security for an amount of 5% of the order value. Performance security may be furnished in the form of Demand draft/FD receipt drawn in favour of "ICAR Unit CPCRI, Kasaragod" payable at SBI, CPCRI Branch, Kasaragod immediately after acceptance of the Tender for placing the order. The performance security valid for a period of 1 year beyond the date of completion of all the contractual obligations including warranty should be furnished within 15 days of acceptance of order. Bid security will be refunded to the successful tenderer on receipt of performance security.
24. If the successful tenderer fails to execute the order within the stipulated period after placing the order, the order will be cancelled and security deposit will be forfeited.
25. Incomplete quotations shall summarily be rejected.
26. This institute is registered with the Department of Scientific & Industrial Research (DSIR), Govt. of India for purposes of availing custom duty exception in terms of Government. Notification No.51/96-Customs dated 23 July 1996 and central excise duty exemption in terms of Government Notification No. 10/97-Central Excise dated 1 March 1997.

Your sealed quotation superscribed as "Quotaion for supply & installation of intercom facility" due on 17-12-2015 may be sent to reach this office on or before on 17-12-2015 at 10 AM. The quotation will be opened in the presence of available tenders/quoters at 11 am on 17-12-2015.

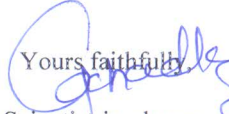
Yours faithfully  
  
Scientist-in-charge

**Installation of EPABX System with Twenty Extensions**

Detailed Description	Qty	Rate	Amount
<b>Item No.A1:Analog EPABX System with Twenty Extensions</b>			
<p><b>Detailed Specifications:</b></p> <p>Lines(Junction): Min 4</p> <p>Extensions: 20 presently and should have the facility to expand up to 28 by adding add-on cards.</p> <p>Control: At least 16 bit Microprocessor based; EPROM 1 Mega bit ; EEPROM :16 Kilo bit; SRAM:256 Kilo bit Static RAM with battery backup</p> <p>Switching: Space Division CMOS Cross point Switch</p> <p>Motherboard that can support the minimum capacity of 4/12</p> <p>Input Power:180 - 260 VAC - 50/60 Hz</p> <p>Maximum power consumption: 40Watts</p> <p>Battery backup with external 12 VDC is a must.</p> <p>Dialing Dial Pulse (DP) :10 pulses per second.</p> <p>Dual Tone Multi-Frequency (DTMF) : 140 milli seconds</p> <p>Dialing conversions : DP – DTMF, DTMF – DP</p> <p>Speech paths:12 (2 paths are reserved for incoming external calls)</p> <p>Connectors: Lines and extensions: 623K4 type</p> <p>External relay and external music: 623K4 type</p> <p>Power and external interfaces: Pin connectors</p> <p>Connectivity: Standard Telephones: 2 wires</p> <p>Call Record Listing (CRL) Capacity Approximately 700 calls</p> <p>Extension interface: Station Loop: Max. 1200 Ohms including the telephone set</p> <p>Max. Line Loop Resistance 2.2 kilo ohms</p> <p>Line Interface : Loop Start with DP and DTMF Signalling : 12/16 KHz Metering Pulse Detection; Polarity Reversal Detection</p> <p>Cabinet should be made of metal</p> <p>Un it should be with Power Supply Module including a power card and cables</p> <p>Unit should have a Power Transformer</p> <p><u>Unit should be equipped with</u></p> <p>1. Operator Console, 2. Inbuilt Key phone Connectivity, 3. Inbuilt Battery Charger; 4. Inbuilt Back Ground Music, 5. Inbuilt DISA/DOSA; 6. Inbuilt Door phone Interface</p> <p>7. Inbuilt Ext Music On Hold Interface; 8.Inbuilt External Paging; 9. Inbuilt Remote Maintenance and Inbuilt Hotel-Motel Features, 10.Auto Redial Facility; 11. Unsupervised Conference; 12.External Call Forwarding.</p>	1		

**Others:**

1. The EPABX should comply with the local exchange communication system parameters.
2. PABX should have the facility to route the line to a predefined extension when switched off.

**Total A1****Item No.A2:Optional Items Required along with item A1**

Sl. No.	Items	Qty	Rate	Amount
1	Caller Line Identification Card to suit with item A1	1		
2	Branded Lead Acid Battery 12V 35AH for backup for item A1	1		
3	Standard Battery Charger (5A minimum) with copper terminal connectors to use with above item A2-2	1		
4	Caller Line Identification Presentation(CLIP) Phones (20 lines +2 standby)	22		

**Total A2****Total (A1+A2)****Item No.B1 Cabling Work**

Sl. No.	Items of Work	Qty	Rate	Amount
1	Branded good quality 20 pair jelly filled underground cable and open cabling charges	130 m		
2	Branded good quality 10 pair jelly filled underground cable and open cabling charges	70 m		
3	Branded good quality 5 pair jelly filled underground cable and open cabling charges	400 m		
4	Branded good quality 50 pair krone box& module	1		
5	Branded good quality 20 pair krone box& module	1		
6	Branded good quality 10 pair krone box& module	6		
7	RJ11 Socket and Box	20		
7	Standard Earthing*  GI Pipe Earthing; Pipe:1 ¼ m length, 1 ½ inch diameter; Copper Earth Wire 14SWG minimum; Earth Pit 1 ¼ mx24cmx24cm filled with charcoal, salt etc as per electrical standards	1		
8	Branded good quality 2 pair copper (0.5 mm) cabling in standard PVC conduits with suitable fixtures, termination through wall fixed rosette boxes at 20 extensions from krone module to telephone instrument at convenient locations	200 rmt		

**Total B1**

Item No.B2.Civil Work				
Sl. No.	Items of Work	Qty	Rate	Amount
1	Earthwork excavation of trenches, width 23cm and depth 75cm for laying underground cables including excavation, dressing of sides , ramming of bottom , removing the excavated soil and then replacing ate soil as required in layers not exceeding 20cm depth and consolidation of each deposited layer by ramming ,watering etc and disposing of surplus excavated soil as directed with in a lead	600 m		
2	Specification as above but for cutting bituminous road portion at 2 different places of length 6 meter approx.	12m		
3	Providing and laying in position 50mm thick cement concrete mix of 1:2:4:using 20mm size jelly and clean sieved approved sand (coarse) over a bed of 100mm thick C.C. 1:4:8(1 cement 4 coarse sand: 8 graded stone aggregate)using 40 mm down size jelly for road cutting stretch. The rate includes the cost of conveyance of all materials, labour ramming curing etc as required.	12m		
			<b>Total B2</b>	
			<b>Total (B1+B2)</b>	

Total expense for the whole system including all components, cabling and related civil works

A1+A2: Analogue EPABX System :-

B1+B2 Cabling Work and Civil Work :-

**Total** :-

**Taxes** :-

**Grand Total** :-

**Rounded to**

(Rupees-----only)

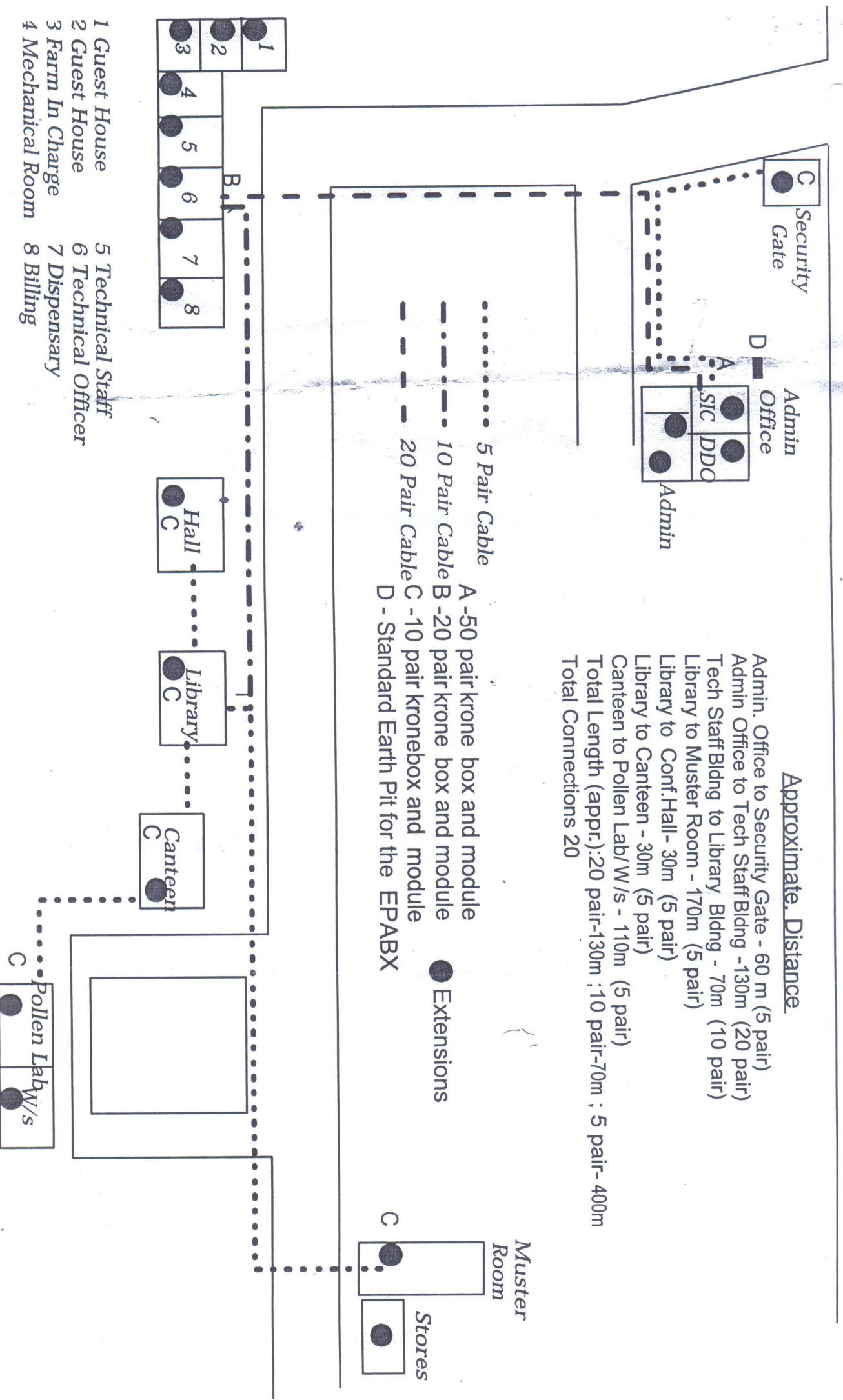

Approximate Distance

- Admin. Office to Security Gate - 60 m (5 pair)
- Admin Office to Tech Staff Bldg -130m (20 pair)
- Tech Staff Bldg to Library Bldg - 70m (10 pair)
- Library to Muster Room - 170m (5 pair)
- Library to Conf.Hall- 30m (5 pair)
- Library to Canteen - 30m (5 pair)
- Canteen to Pollen Lab/W/s - 110m (5 pair)
- Total Length (appr.):20 pair-130m ; 10 pair-70m ; 5 pair- 400m
- Total Connections 20

..... 5 Pair Cable

- . - . 10 Pair Cable

--- 20 Pair Cable

D - Standard Earth Pit for the EPABX

● Extensions

- 1 Guest House
- 2 Guest House
- 3 Farm In Charge
- 4 Mechanical Room
- 5 Technical Staff
- 6 Technical Officer
- 7 Dispensary
- 8 Billing