

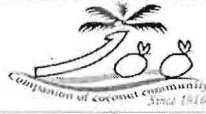

Phone (08) : 04994 - 232333
Fax : 04994 - 232322
EPABX : 04994 - 232893 - 95
04994 - 232090
04994 - 232996



E-mail : director.cperi@icar.gov.in
director.cperi@gmail.com
chowdappa.p@icar.gov.in
Website : <http://www.cperi.gov.in>

F.No.40(3)/2015 -Estate

Date :28.11.2016

Shri Naveena B
Srimatha Kripa
Vishnu Murthi Nagar
Bela P.O, Kasaragod

Sub : Work 'Reconstruction of masonry steps near bund by the side of DJ building for rearranging ornamental plants at ICAR-CPCRI, Kasaragod-reg.

Ref : Your quotation dated 17.06.2016

Sir,

Your quotation cited above to execute the work "Reconstruction of masonry steps near bund by the side of DJ building for rearranging ornamental plants at ICAR-CPCRI, Kasaragod " at a total cost of Rs.1,21,783/- (Rupees one lakh twenty one thousand seven hundred and eighty three only) has been accepted and accordingly the work is hereby awarded to you for execution. You are therefore requested to take up the work and complete the same within 45 days. The order is further subject to the following terms and conditions.

Terms and conditions:

1. The work should be executed strictly as per the directions from the Technical Officer (Civil Engineering) of the Institute from time to time.
2. The Institute will not be responsible for any loss/damage/casualty suffered by the Contractor while executing the work, provided there wasn't any mistake on the part of the contractor.
3. Any loss or damage etc. caused to the Institute properties while carrying out the work should be made good failing which necessary action will be initiated to recover the cost of the same.
4. No work tools/implements will be supplied by this Institute.
5. The payment will be made only after satisfactory completion of the whole work to our satisfaction & as per specification.
6. No part payment is payable.
7. All the work should be carried out as per CPWD/MES specifications.
8. Non-completion of the work or part thereof for any invalid reasons within the period prescribed is liable for cancellation and no claims for such works will be entertained under any circumstances and deposits made thereof will be forfeited.

9. **Defects liability period:** Performance Security will be released only **after six months** from the date of completion of the work provided that the contractor has attended to all the complaints informed to him within the liability period.
10. The contractor or his worker should not use the office toilets and should not waste the water from the office building.
11. Any defective workmanship found shall be rectified at his cost which may include the materials spoilt/wasted paints due to negligence etc.
12. The contractor shall, on written request of the Director or his representative on the site, immediately dismiss from the work any person employed by him thereon, who may in the opinion of the Director be incompetent or misbehaves himself and such persons shall not again be allowed to work without the written permission of the Director.
13. On completion of the work it should be ensured that premises & its surroundings are cleaned (including removal of paints fallen etc.)
14. Income Tax @ 1% of the bill will be deducted from the work bill. VAT @ 4% of the contract amount will be deducted from the work bill, if registered with Sales Tax Department. Otherwise @ 10.0%.
15. Prior permission may be obtained for electricity/water facility, if required, subject to payment for the same.
16. The period of 45 days allowed for carrying out the work will be reckoned after 10 days from the date of receipt of this order.
17. **The contractor shall debit the Performance Security within 10 days from the issue of work order. The period can be further extended at the written request of the contractor for the period of 10 days with late fee at the rate of 0.1% per day of Performance Security amount.**
18. The work should be completed within the time limit itself failing which the work order will be cancelled and action taken to complete the remaining work at your risk and cost including forfeiture of security deposit.
19. In case any extension of time is granted beyond the stipulated period for completion of the work due to any unavoidable genuine circumstances as may be decided by the competent authority, penalty clause to be imposed @ 0.25% per month (maximum to 2.5% of the total cost of the work) if work not completed within schedule time or within mutually extended period.
20. The Director of this Institute reserves the right to reject the work as a whole, if the execution is not satisfactory or does not conform to the approved specification.
21. In the event of change of address, that may be informed to the office immediately.

You may remit a Performance Security of **Rs.12,178/- (Rupees twelve thousand one hundred and seventy eight only)** being the 10% of contract value by DD, FD Receipt or Bank Guarantee from the Commercial Bank in an acceptable form before commencement of the work. The Bid Security deposited along with the tender will be refunded immediately on furnishing the Performance Security (If bank guarantee is produced the period of release of bank guarantee will be given by the office including release of the same).

Please acknowledge receipt of this order and confirm acceptance within 7 days from the date of receipt of this letter.

Yours faithfully,

Assistant Administrative Officer (Estate)

Copy to :

1. The Asst. Labour Commissioner(Central), Office of the Regional Labour Commissioner, Kendriya Shram Sadan, Olimugal, By pass Road, Kakkanad, Kochi 682 030.
2. The Finance and Accounts Officer, CPCRI, Kasaragod. **Head of Account "118203 Repair and Maintenance of Office buildings– Petty Minor Works (Non-Plan)2016-17.**
3. The AAO(Bills), CPCRI, Kasaragod.
4. Technical Officer (Civil Engineering) CPCRI, Kasaragod, it may please be ensured that the contractor is permitted to commence the work at the work site immediately on receipt of security deposit. It may be ensured work is completed within the prescribed time and according to the specifications as approved. The date of commencement of the work awarded may be intimated and progress of work reported periodically.
5. The Secretary, IJSC, CPCRI, Kasaragod
- ✓ 6. CPCRI, Website.

Yours faithfully,

Assistant Administrative Officer (Estate)



भाकृअनुप - केन्द्रीय रोपण फसल अनुसंधान संस्थान
कासरगोड, केरल - 671 124 भारत
ICAR - Central Plantation Crops Research Institute
Kasaragod - 671 124, Kerala, India
(An ISO 9001:2008 Certified Institution)



Phone (Off) : 04994 - 232333
Fax : 04994 - 232322
EPABX : 04994 - 232893 - 95
04994 - 232090
04994 - 232996



E-mail : director.cperi@icar.gov.in
directoreperi@gmail.com
chowdappa.p@icar.gov.in
Website : http://www.cperi.gov.in

F.No.40(3)/2015-Estate

Date.28.11.2016

Name of the work: 'Reconstruction of Masonry steps near bund by the side of DJ building for rearranging ornamental plants at CPCRI, Kasaragod'-671 124

WORK SCHEDULE

Sl. No	Description of the work	Unit Rate	Approx. Qty	Rate quoted	Amount (Rs.)
1)	Labour charges towards removing the drain cover slab , laterite stones and stacking to the sides with a lead of 30mts and a lift of 1.50 m as directed.	Lump Sum	Lump sum	7,000	7,000
2)	Earth work in excavation by manual or by mechanical means in foundation trenches or drains (not exceeding 1.5 m in width or 10 sqm on plan), including dressing of sides and ramming of bottoms, lift upto 1.5 m, including getting out the excavated soil and disposal of surplus excavated soil as directed, within a lead of 50 m. All kinds of soil	Cumt	7.00	600	4,200
3)	Providing and constructing Hard laterite neatly dressed stone masonry in cement mortar 1:6 for foundation and basement including cost and conveyance of all material to site and all labour charges to complete. as per CPWD Specifications as the direction of departmental officers	Cumt	17.00	4,000	68,000
4)	Filling available excavated earth (excluding rock) in trenches, plinth, sides of foundations etc. in layers not exceeding 20cm in depth, consolidating each deposited layer by ramming and watering, lead up to 50 m and lift upto 1.5M	Cumt	5.00	300	1,500

5	Providing and removing centering, shuttering, strutting, propping etc, removal of form work for flat surfaces such as suspended floors roofs slabs, sunshade, lintel and likes, thickness upto 200 mm including cost of all material labour, complete as per specification.				
5(A)	Lintel , Beams ,plinth beam, slabs and cantilevers	Sq.mt.	6.00	500	3,000
6)	Providing and fabricating steel reinforcement including straightening, cutting, bending, hooking, lapping wherever necessary placing in position, tying with binding wire including anchoring to the adjoining member wherever necessary as per design, drawing and specification. The rate shall include cost and conveyance of all materials transportation, cost of steel, fabrication etc complete as directed. (THERMO MECHANICALLY TREATED BARS)	Kgs	105	50	5,250
7)	Providing and laying of R.C.C works using C.C 1:1.5:3 mix (1 cement: 1.5 coarse sand: 3 graded stone aggregate) using 20 mm and down size jelly (graded) and clean sieved approved sand. The work shall include cost and conveyance of all materials using MACHINE MIXING, MECHANICAL VIBRATORS, well compacted including cost and conveyance of all materials, centering, Form work, placing the reinforcement into position and finishing the exposed surfaces in C.M 1:3, (1 cement: 3 coarse sand) for entire completion of work as directed (RATE TO EXCLUDE COST OF STEEL, FABRICATION, CENTRING & SHUTTERING) upto floor five level				
7(A)	RCC Beams/Lintel/shades /slab 1:1 1/2 :3 (12cms thick)	Cumt	1.51	3,300	4,983
8)	Providing and plastering the wall surfaces in CM 1:4 (1 cement: 4 coarse sand), 12 mm thick, using clean sieved approved sand with TAPI/TROWEL FINISH. The rate shall include cost and conveyance of all materials, scaffolding, labour, curing etc., complete	Sqmt	37.00	450	16,650
9)	Providing and laying 60mm thick factory made cement concrete interlocking paver block of M -30 grade made by block making machine with strong vibratory compaction, of approved size, design & shape, laid in required colour and pattern over and including 50mm thick compacted bed of coarse sand, filling the joints with fine sand etc. all complete as per the direction of Engineer-in-charge.	Sqmt	14.00	800	11,200
Grand Total Rs.					1,21,783/-

Total Rs.1,21,783/-(Rupees one lakh twenty one thousand seven hundred and eighty three only)

 सहायक प्रशासनिक अधिकारी (एस्टेट)
 Assistant Administrative Officer (Estate)
 केंद्रीय रोपण फसल अनुसंधान संस्थान
 Central Plantation Crops Research Institute
 कासरगोड, केरल Kasaragod - 671 124, Kerala

RECONSTRUCTION OF MASONRY STEPS NEAR BUND FOR REARRANGING ORNAMENTAL PLANTS

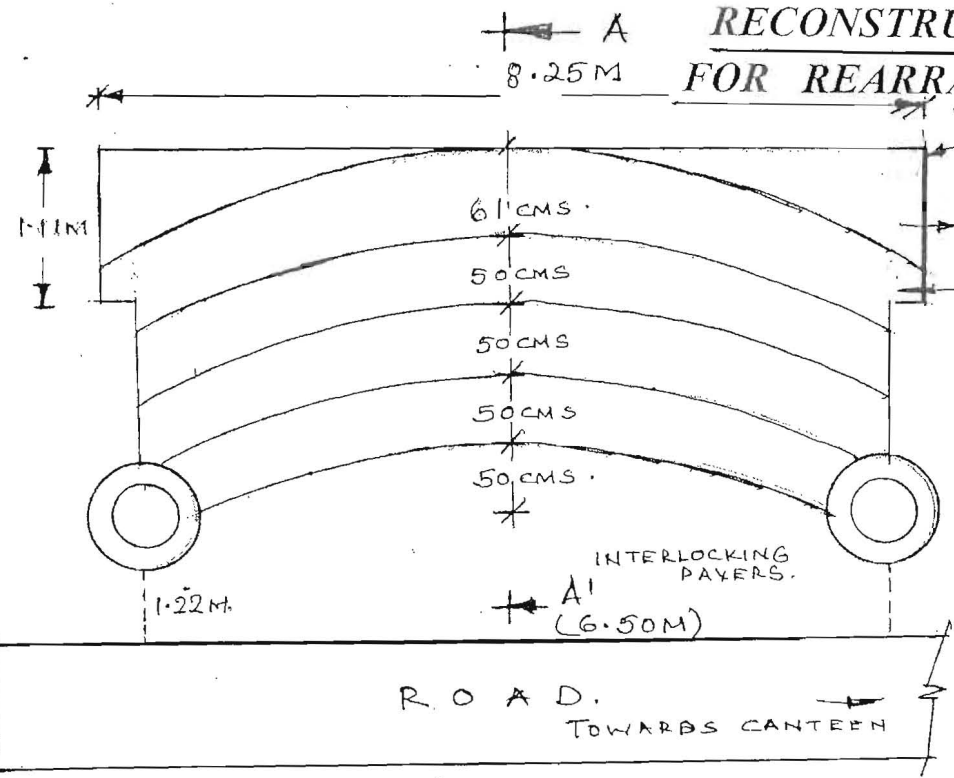

R.C.C. SLAB IN C.C. 1:1/2:3,
12CMS THICK
DRAIN -
MASONRY STEPS USING
LATERITE STONES.

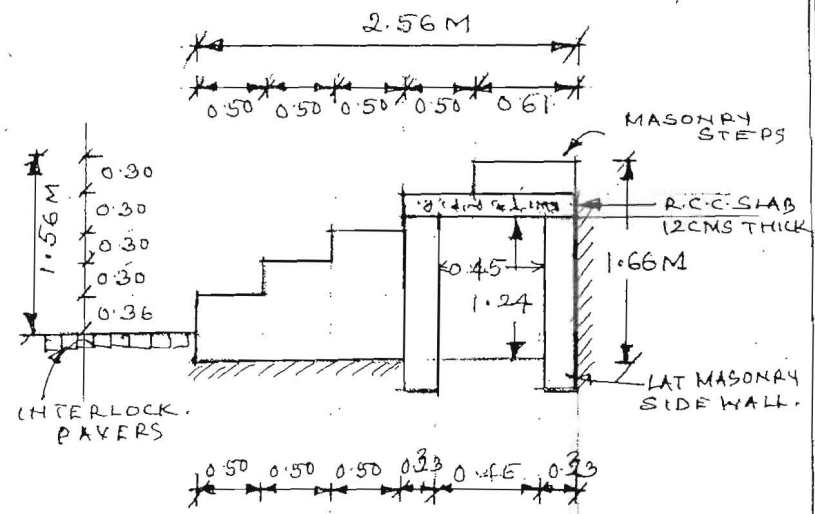

PLAN.

CROSS SECTION.